

# Diesel Pre-Heat Module

"Finally, an environmentally sealed device with timing, temperature sensing, and switching in a single, economical ISO package..."



Trombetta's Diesel Pre-Heat Module is a temperature sensing and timing module designed to provide optimum control of Diesel Engine/Cold Starting Assist devices such as glow plugs and air intake heaters. It includes a provision to drive common dash mounted indicator lamps.



Environmentally sealed, this robust and economical module enables cold-weather starting of diesel engines with loads up of 40 amps. Customization for your specific needs is available.

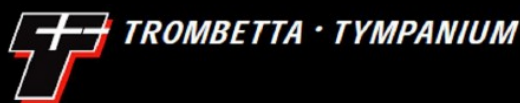

Engineering Excellence. Worldwide Competitiveness.

## Diesel Pre-Heat Module Family Specifications

Housing	Nylon
Pin-Out Configuration	Standard ISO 7588-1 Pattern
Voltage Range	6 Volts DC to 18 Volts DC
Sealing	IP 66/67 Rating
Wait Lamp Output	Transistor output between Pin 1 and Pin 5. Maximum 400mA resistive load. Designed to drive a GE 194 lamp or equivalent.
Glow Plug Output	Relay contact between Pin 2 and Pin 4. Maximum 40A resistive load.
Transient Protection	30 volts - Protects the module from other components that may create voltage spikes.

## Description of Operation

With key in the run position, an indicator light will turn on and remain on while the glow plug reaches the required pre-set temperature. After the light turns off the operator can turn the key to crank the engine. The glow plug will remain energized for a pre-determined time based on the ambient temperature.

## On-Times Based on Temperature

Temperature	User Wait Lamp On-Time	Glow Plug On-Time
-20° C	9 sec.	30 sec.
0° C	6 sec.	22 sec.
20° C	4 sec.	15 sec.
40° C	1 sec.	8 sec.
60° C	Off	4 sec.
75° C or greater	Off	3 sec.

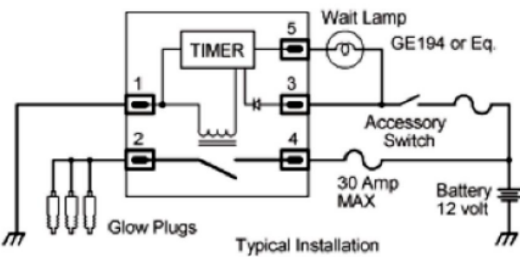
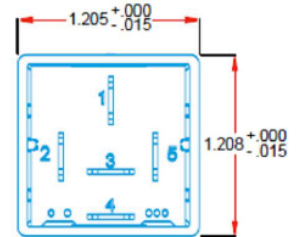
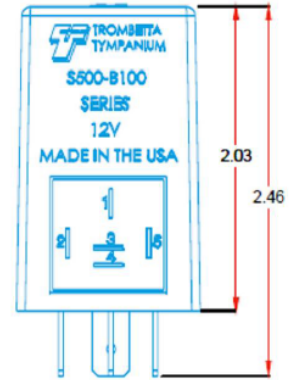

Foot Print

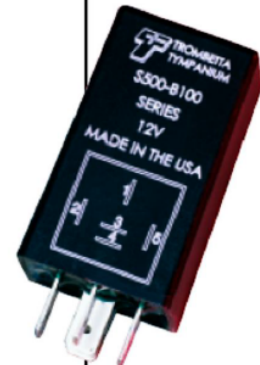
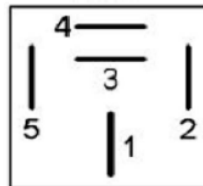

Trombetta's Diesel Pre-Heat Module directly replaces Delphi and Bosch Modules. Can be customized for your application.